

Rivet Shelving

SpeedRack offers a light duty long span shelving system that is ideal for Medium weight applications. Rivet Shelving is manufactured from high quality steel, which is then powder coated, providing an affordable and extremely versatile storage system.

Each Bay of Rivet Shelving is free standing. Using Four single angle uprights, each bay is built individually, where other shelving systems have common uprights and add on bays.

Rivet Shelving is a bolt free adjustable shelving system. It is quick and easy to build and no tools are needed. Each Beam level slips easily into place and can be adjusted within 40mm. Shelf levels can be easily adjusted or added.



Angle Post

Standard and heavy-duty angle posts are available. Rivet Shelving Angle posts have 38.1mm hole centers, and we are able to manufacture to individual customer height requirements.



2-9

Standard Angle Post

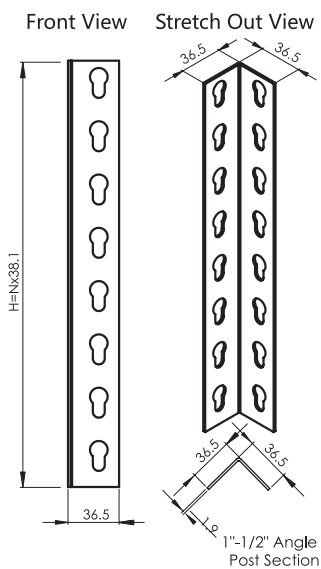

Heavy-duty Angle Post

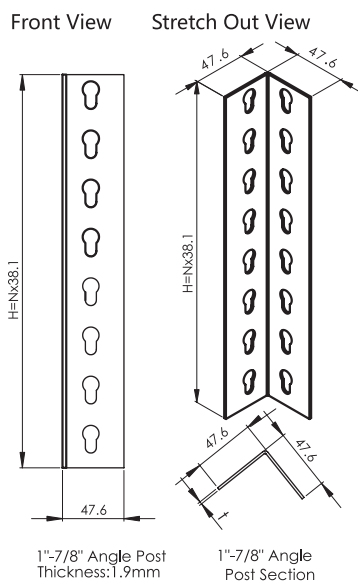

Rivet Beam

“L” Type Rivet Beam (16Ga / 14Ga)

Light duty beam able to be manufactured to customer specifications.

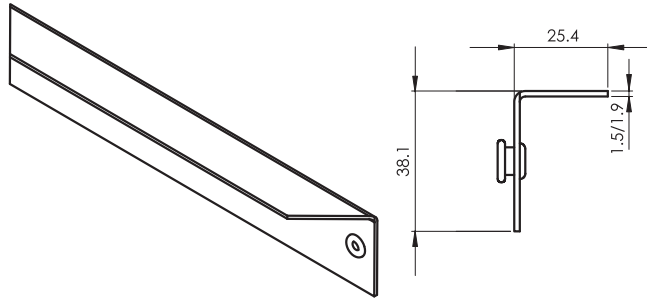

“Z” Type Rivet Beam (16Ga / 14Ga)

Provides increased load capacity in the longer lengths and protects decking edges.

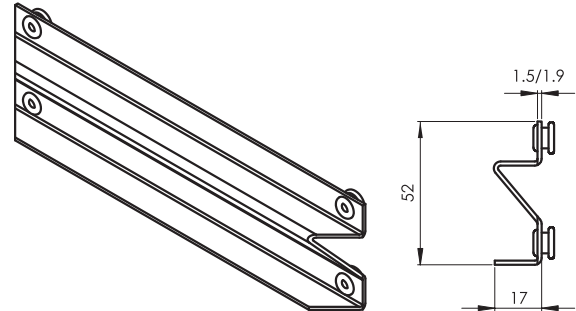

“C” Type Rivet Beam (16Ga / 14Ga)

Designed to provide maximum left to right stability and higher capacity. The front side has holes for fastening C Type Shelves Supporter.

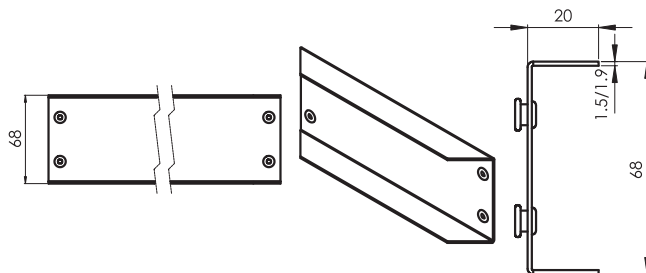

“C” Type Shelf Supportor (16Ga / 14Ga)

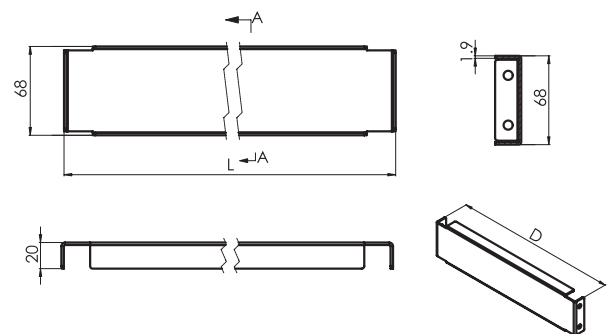

Shelves

Various Shelves are available for different requirements.

Chipboard Shelves

- Chipboard is available pre - cut to fit longspan shelving. This is the most cost effective shelving for the system.



Melamine Faced Shelves

- Provide a wipe clean surface where high levels of cleanliness are required such as in pharmaceutical or electronic industries.

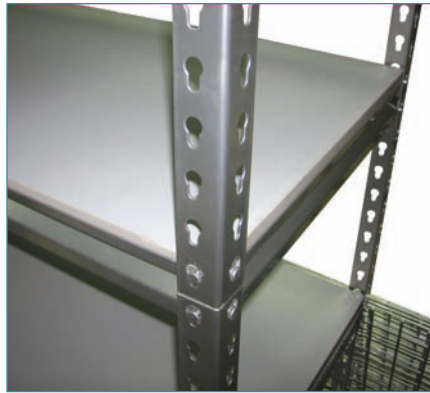

Steel Shelves

- We provide both Zinc Plated and Powder Coated steel shelves.



Wiremesh Shelves

- Wiremesh Shelving is available on all Rivet Shelving System. SpeedRack offers a variety of sizes, capacities, and custom configurations to accommodate any application.

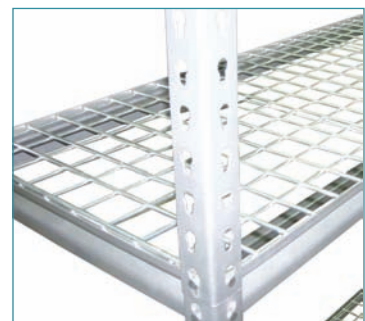

Accessories



Plastic Base Plate



Double-side Steel Base Plate

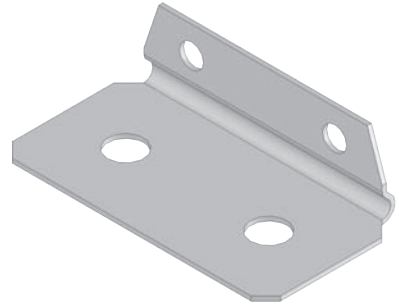

Single-side Steel Base Plate

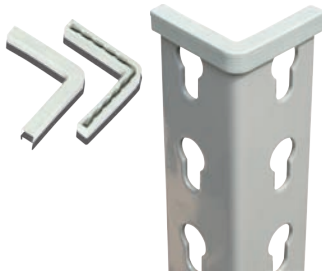

Top Angle Post Endcover



Plastics Angle Post Connector



4 Rivets Angle Post Connector



Rivet Shelving Application

The structural integrity of SpeedRack Rivet Shelving lends itself to use in storage facilities for lots of applications.



Rivet Shelving Construction

STEP 1: Bottom Shelf

1. Components:
 - 4 Posts.
 - 2 Front & Back Beams.
These are the steel beams that support the front and back of the shelf.
 - 2 Left & Right Beams.
These are the steel beams that support the sides of the shelf.
2. Build the bottom shelf by inserting the Beams into the bottom keyholes of each post using a rubber hammer.

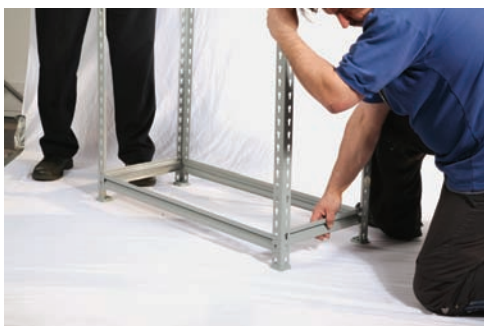

FIG.1

STEP 2: Top Shelf

Build the top shelf by inserting the Beams into the top keyholes of each post using a rubber hammer.



FIG.2

STEP 3: Middle Shelves

1. Components:
 - 2 Front & Back Beams.
These are the steel beams that support the front & back of the shelf.
 - 2 Left & Right Beams.
These are the steel beams that support the sides of the shelf.
2. Determine the spacing. Insert each Z-Beam into keyholes.
3. Repeat steps 1-2 for each additional shelf.



FIG.3

STEP 4: Shelves

1. Place one shelf on each level.



FIG.4

Special Notes:

1. It is recommended that a rubber mallet be used to position the beam securely into place.
2. Cardboard or carpet can be used to protect flooring.